

MARKUS XS

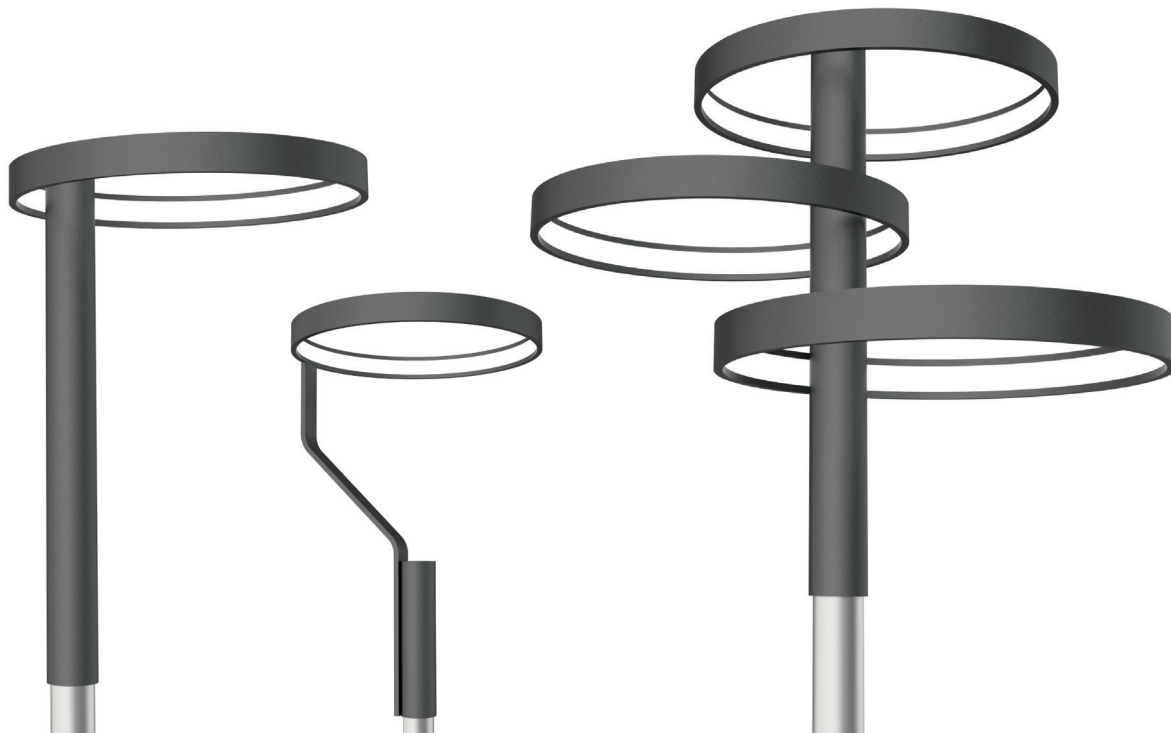

			>80 CRI	W 3000 K	N 4000 K	IP65 EN 60529	230 V 2014/35/UE	50/60 Hz	IK 09 EN 60068	850° EN 60695		RG 0 EN 62471
2,5 Kv				08 BLACK METALLIZED	5Y WARRANTY 5% FAILURE RATE	50.000 h LED LIFETIME L80B20	CAE ON/OFF					

EN

Extruded calendered aluminum body painted with epoxy powders after phosphating. Body and arms designed to obtain a reduced wind exposure surface. Extruded polycarbonate wide beam optic. Opal polycarbonate closing reflector. Fixed pole-top installation (60 mm diameter pole head). LED light source. Direct light emission.

IT

Corpo in alluminio estruso calandrato, verniciato con polveri epossidiche previa fosfatazione. Corpo e bracci con dimensioni ridotte per ottenere una bassa superficie d'esposizione al vento. Ottica diffondente in polycarbonato estruso. Schermo di chiusura in polycarbonato opalino. Installazione fissa cima palo (testa palo diametro 60 mm). Sorgente luminosa LED multichip. Emissione diretta.

FR

Corps en aluminium extrudé calandré peinture à base de poudre époxyde et traitement de surface No-Rinse. Corps et bras conçus pour garantir une surface très réduite d'exposition au vent. Optique de diffusion en polycarbonate extrudé. Écran de fermeture en polycarbonate opale. Raccord fixe au sommet du mât (extrémité du mât 60 mm de diamètre). Source lumineuse LED. Emission directe.

ES

Cuerpo de aluminio calandrado extruido, barnizado con polvo epoxi previa fosfatación. Carcasa y brazos diseñados para conseguir una superficie reducida de resistencia al viento. Óptica difusora de policarbonado extruido. Difusor de policarbonado opal. Instalación fija en la parte superior del poste (60 mm de diámetro cabeza del poste). Fuente de luz LED. Emisión directa.

DE

Körper aus extrudiertem, kalandriertem Aluminium, der nach der Phosphatierung mit Epoxidpulvern lackiert wurde. Entworfener Körper und Arme für eine reduzierte Windfläche. Streuoptik aus extrudiertem Polycarbonat. Abdeckschirm aus opalem Polycarbonat. Feste Polkopfinstallation (Polkopfdurchmesser 60 mm). LED-Lichtquelle. Direkte Lichtemission.

RU

Корпус из экструдированного каландрированного алюминия, окрашенного эпоксидными порошками после фосфатирования. Корпус и опоры предназначены для достижения уменьшенной площади поверхности воздействия ветра. рассеивающая оптика из экструдированного поликарбоната Дорожная оптика из литого ПММА с высокой оптической эффективностью. Светодиодный источник света. Прямой поток света.

MARKUS XS A



Code	Lm LED	Lm Out	Watt Out	Lm Watt Out
KMRSA1W/N08	2250	1125	18	> 63
KMRSA2W/N08	4500	2250	36	> 63

W/N= **W** (3000 K) | **N** (4000 K)

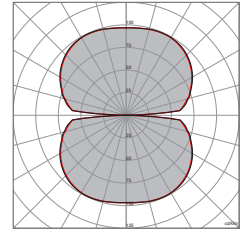

Lm Led/Lm Out:
Standard - **N** (4000 K)
-8% - **W** (3000 K)

MARKUS XS B

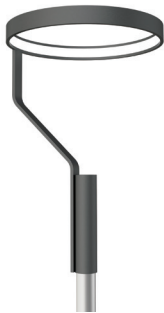

Code	Lm LED	Lm Out	Watt Out	Lm Watt Out
KMRSB1W/N08	2250	1125	18	> 63
KMRSB2W/N08	4500	2250	36	> 63

W/N= **W** (3000 K) | **N** (4000 K)

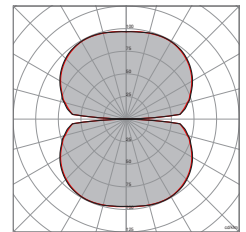

Lm Led/Lm Out:
Standard - **N** (4000 K)
-8% - **W** (3000 K)

MARKUS XS C



Code	Lm LED	Lm Out	Watt Out	Lm Watt Out
KMRSC5W/N08	6750	3375	54	> 63

W/N= **W** (3000 K) | **N** (4000 K)

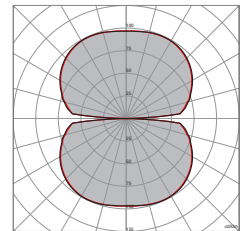

Lm Led/Lm Out:
Standard - **N** (4000 K)
-8% - **W** (3000 K)



Code

Code Ordering example: **KMRSA1 W/N 08**

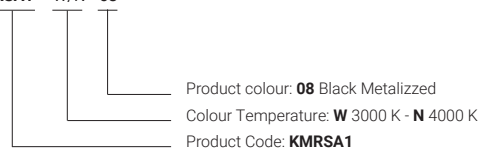

MARKUS XS

DIMENSIONAL

MARKUS XS A

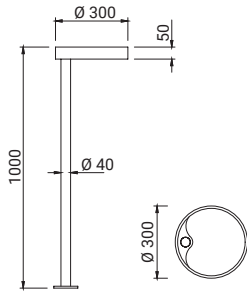

DIMENSIONAL

MARKUS XS B

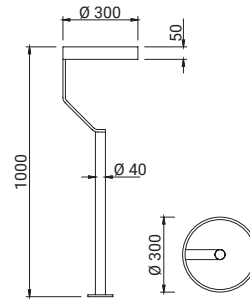

DIMENSIONAL

MARKUS XS C

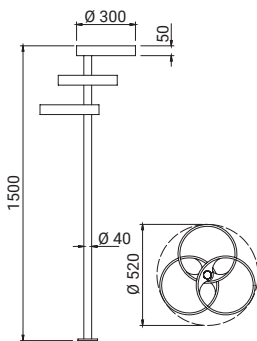

WIND RESISTANCE

MARKUS XS A

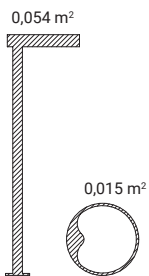

MARKUS XS B

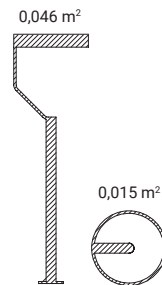

MARKUS XL C

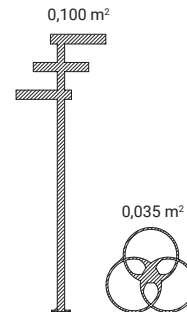

WEIGHT (Kg)

MARKUS XS A: **4,0**
 MARKUS XS B: **4,5**
 MARKUS XS C: **5,5**

MINIMUM AND MAXIMUM ENVIRONMENT TEMPERATURE (Ta)

MARKUS XS A - B - C: **-20 ~ +45°C**