

WALLEY XP 2

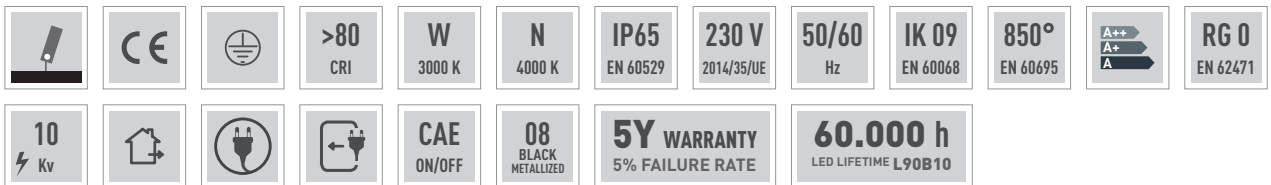

EN

Extruded anodized aluminum body with heat-sink function. Bent steel adjustable bracket and frame painted with epoxy powders after phosphating complete with goniometer. Direct light emission. Street optics in high performance optical molded silicone with high mechanical resistance, anti-yellowing and anti-scratch. LED light source. IP66 quick plug-in connector for power line included. High frequency (CAE) ballast in separate IP65 box fixed to the body.

ES

Cuerpo en aluminio extruido anodizado con función de disipador. Marco y soporte regulable de acero plegado a presión barnizado con polvo epoxi previamente fosfatado, completo de goniómetro. Emisión directa. Óptica vial en silicona estampada de alto rendimiento con alta resistencia mecánica, anti-amarilleo y anti-rayado. Fuente de luz LED. Conector rápido IP66 para alimentación incluido. Alimentación electrónica CAE externa, IP65 fijada al cuerpo.

IT

Corpo in alluminio estruso anodizzato con funzione di dissipatore. Telaio e staffa regolabile in acciaio pressopiegato verniciati con polveri epossidiche previa fosfatazione, completa di goniometro. Ottiche stradali in silicone stampato ad alto rendimento ottico con elevata resistenza meccanica, anti-ingiallimento ed antigraffio. Emissione diretta. Sorgente luminosa LED. Connettore rapido IP66 per linea di alimentazione incluso. Alimentazione elettronica CAE esterna, IP65 fissata al corpo.

DE

Körper aus eloxiertem extrudiertem Aluminium mit Kühlkörperfunktion. Rahmen und verstellbare Halterung aus gepresstem Stahl, der nach der Phosphatierung mit Epoxidpulver lackiert wurde, komplett mit Goniometer. Straßenoptik aus optisch geformtem Hochleistungssilikon mit hoher mechanischer Beständigkeit, Vergilbungs- und Kratzfestigkeit. Direkte Lichtemission. LED-Lichtquelle. Direkte Ausgabe. IP66-Schnellverbinder für Stromleitung enthalten. Externe elektronische Stromversorgung, IP65 am Gehäuse befestigt.

FR

Corps en aluminium extrudé et anodisé avec fonction de dissipateur. Support de fixation réglable, pliée à la presse, en acier traité avec peinture epoxy pulvérisé par phosphatation. Émission directe. Optiques routières encapsulées dans le silicone moulé offrant une haute transparence optique, résistance mécanique élevée, et un fort indice de réfraction. Forte résistance aux UVs, aux chocs et aux rayures. Source lumineuse LED. Connecteur rapide IP66 pour ligne électrique incluse. Alimentation électronique CAE externe IP65 fixée au corps.

RU

Анодированный экструдированный алюминевый корпус с функцией радиатора. Регулируемая рама и кронштейн из гнутой фосфатированной стали, окрашенные эпоксидными красками-порошками, в комплекте с транспортом. Уличная оптика из высокоэффективного оптического литого силикона с высокой механической прочностью, устойчивого к пожелтению и царапинам. Прямой поток света. Светодиодный источник света. Быстроразъемное соединение IP66 для линии электроподключения включено в комплект. Внешний электронный блок питания CAE, IP65 закреплен на корпусе.

WALLEY XP 2 AS



Code	Lm LED	Lm Out	Watt Out	Lm Watt Out	Relamping
KWYX24013ASW/N08	15720	11310	100	> 113	250
KWYX24016ASW/N08	18500	13300	123	> 108	250
KWYX26013ASW/N08	22840	16230	147	> 110	250
KWYX26016ASW/N08	27680	19915	191	> 104	400
KWYX28016ASW/N08	28200	20425	184	> 111	400
KWYX28018ASW/N08	31200	22070	202	> 109	400
KWYX28021ASW/N08	35400	25585	244	> 105	400

W/N= **W** (3000 K) | **N** (4000 K)

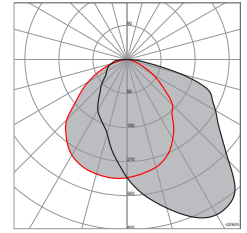

Lm Led/Lm Out:
Standard - **N** (4000 K)
-8% - **W** (3000 K)

WALLEY XP 2 AS2



Code	Lm LED	Lm Out	Watt Out	Lm Watt Out	Relamping
KWYX24013AS2W/N08	15720	10875	100	> 109	250
KWYX24016AS2W/N08	18500	12800	123	> 104	250
KWYX26013AS2W/N08	22840	15610	147	> 106	250
KWYX26016AS2W/N08	27680	19150	191	> 100	400
KWYX28016AS2W/N08	28200	19640	184	> 107	400
KWYX28018AS2W/N08	31200	21220	202	> 105	400
KWYX28021AS2W/N08	35400	24290	244	> 100	400

W/N= **W** (3000 K) | **N** (4000 K)

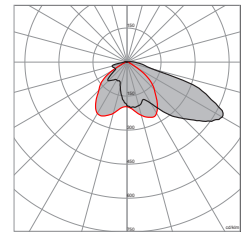

Lm Led/Lm Out:
Standard - **N** (4000 K)
-8% - **W** (3000 K)

WALLEY XP 2 D



Code	Lm LED	Lm Out	Watt Out	Lm Watt Out	Relamping
KWYX24013DW/N08	15720	11750	100	> 118	250
KWYX24016DW/N08	18500	13820	123	> 112	250
KWYX26013DW/N08	22840	16850	147	> 115	250
KWYX26016DW/N08	27680	20680	191	> 108	400
KWYX28016DW/N08	28200	21210	184	> 115	400
KWYX28018DW/N08	31200	22920	202	> 114	400
KWYX28021DW/N08	35400	26230	244	> 108	400

W/N= **W** (3000 K) | **N** (4000 K)

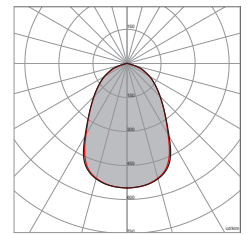

Lm Led/Lm Out:
Standard - **N** (4000 K)
-8% - **W** (3000 K)

WALLEY XP 2 C



Code	Lm LED	Lm Out	Watt Out	Lm Watt Out	Relamping
KWYX24013CW/N08	15720	11455	100	> 115	250
KWYX24016CW/N08	18500	13475	123	> 110	250
KWYX26013CW/N08	22840	16440	147	> 112	250
KWYX26016CW/N08	27680	20170	191	> 106	400
KWYX28016CW/N08	28200	20690	184	> 112	400
KWYX28018CW/N08	31200	22350	202	> 111	400
KWYX28021CW/N08	35400	25550	244	> 105	400

W/N= **W** (3000 K) | **N** (4000 K)

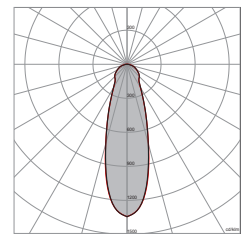

Lm Led/Lm Out:
Standard - **N** (4000 K)
-8% - **W** (3000 K)



Code Ordering example: **KWYX24013 AS W/N 08**

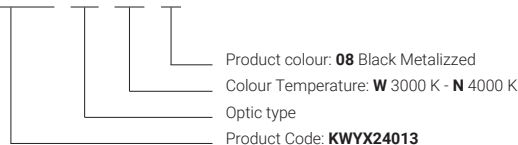

WALLEY XP

DIMENSIONAL + FIXTING

WALLEY XP 2

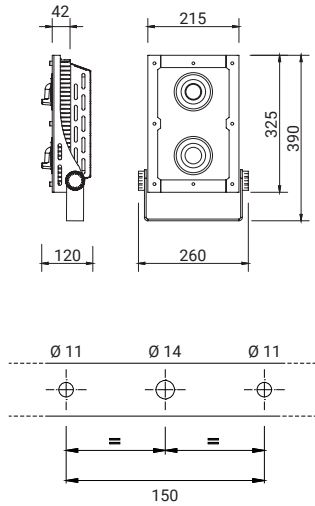

WIND RESISTANCE

WALLEY XP 2

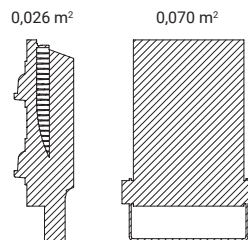

WEIGHT (Kg)

6,0

MINIMUM AND MAXIMUM ENVIRONMENT TEMPERATURE (Ta)

-20 ~ +45°C